



**Application:** 1997-2013 Corvette

**Part Includes**

1 - Component

## Front Sway Bar



### Tools Needed



Search: *Suspension and Chassis*

[www.mamotorworks.com](http://www.mamotorworks.com)

#### STEP 1.

Start by breaking the lug nuts loose on your front wheels.

#### STEP 2.

Then securely raise and support the vehicle so the front tires are suspended and you have adequate space to work under the front of the vehicle.

#### STEP 3.

Remove the lug nuts and front wheel, tire assemblies.

#### STEP 4.

Next loosen and remove the nuts from the sway bar end links on both sides of the vehicle. (A)

#### STEP 5.

Remove the four sway bar insulator retaining bolts from the front cross member. (B)

#### STEP 6.

Hold the new front sway bar in place and install the insulator brackets and bolts into the front cross member. (Tighten to 43 lb ft) (B)

#### STEP 7.

Install the front sway bar end links on both sides of the vehicle. (Tighten to 56 lb ft) (A)

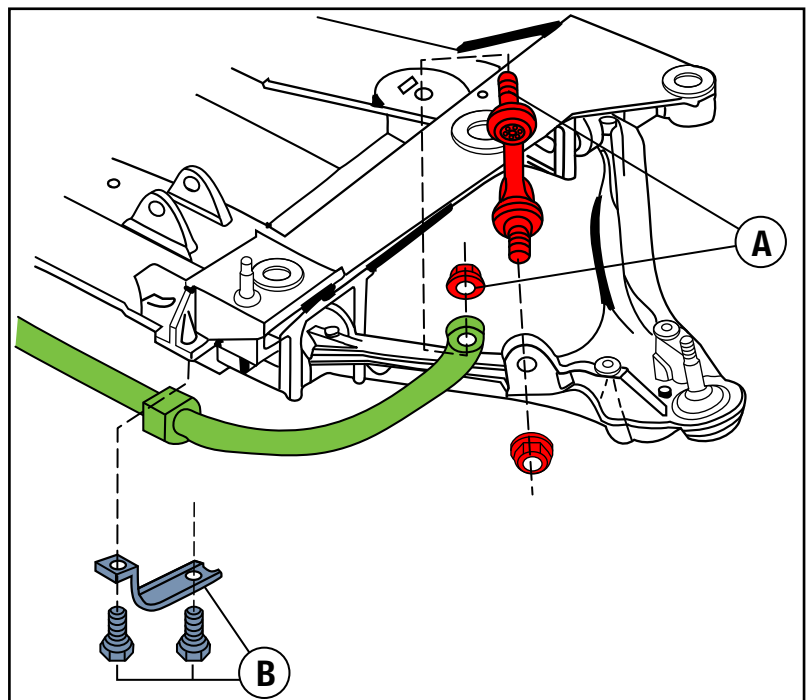

Mamotorworks



@CorvettePassion



MidAmericaMotorworks



CorvettePassion

2900 North Third Street, Effingham, IL 62401

800.500.1500 • Worldwide: 217.540.4200 • FAX: 217.540.4800

[www.mamotorworks.com](http://www.mamotorworks.com) • [generalmail@mamotorworks.com](mailto:generalmail@mamotorworks.com)

©Mid America Motorworks, Inc. All rights reserved.