



**Application:** 1980-1982

**Part Includes**

1 - Components

## GM Style Strut Rod With Urethane Bushings



### Tools Needed



Search: *Suspension and Chassis*  
[www.mamotorworks.com](http://www.mamotorworks.com)

Due to different factory suppliers and parts, General Motors used several different castings of bearing carriers on the assembly line. We've found at least 4 to 5 different designs on 1963-82 Corvettes.

Within these variations, we've found differences in machining tolerances creating flash or excess material on the inner edges of the "forks" (See Item #1) of the bearing carrier which may need to be dressed down using a file or small hand grinder (at most, only a few thousandths of an inch) to

achieve a perfect fit. We have manufactured these strut rods and bushings to meet the most common measurements.

You may also wish to trim the outer flange of the urethane bushings where it contacts the unmachined inner forks (See Item #2). These operations will allow you to achieve a tight, custom fit for maximum handling stability.

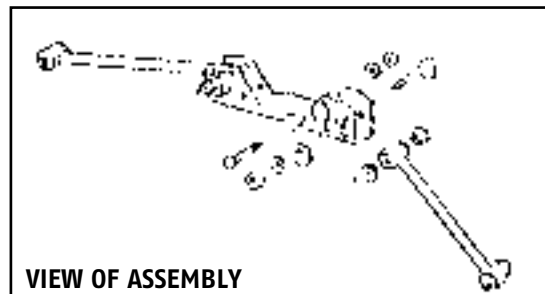
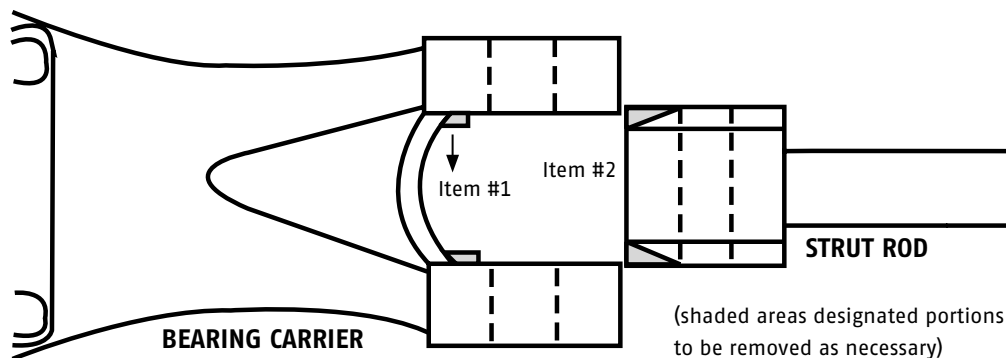

Mamotorworks



@CorvettePassion



MidAmericaMotorworks



CorvettePassion

**2900 North Third Street, Effingham, IL 62401**

**800.500.1500 • Worldwide: 217.540.4200 • FAX: 217.540.4800**

**[www.mamotorworks.com](http://www.mamotorworks.com) • [generalmail@mamotorworks.com](mailto:generalmail@mamotorworks.com)**

©Mid America Motorworks, Inc. All rights reserved.