



Application: 2008–2013 and 2006–2013 LS7



Search: **Air Intake Systems**
www.mamotorworks.com

Part Includes

- 1 - Black Wing Induction System
- 1- Hardware Kit
- 1- Adhesive, 3m

Blackwing Induction System



Tools Needed



WARNING: SLP recommends wearing safety glasses for the complete installation.

WARNING: To avoid the chance of electrical shock or damage to your vehicle's electrical system, disconnect both the negative and positive battery leads (in that order) at the battery.

STEP 1.

Remove the stock air boxes and duct from the inlet of the stock rubber bellows forward.

STEP 2.

Install the 2 Binding Barrels with flat head screws onto the supplied flat black bracket as shown in the photo.

STEP 3.

Next install the supplied frame nuts using the supplied 3M adhesive. See 3 photos at right for placement of frame nuts. Use the 3M adhesive on the backside of the frame nut flanges. Insert the frame nut into the frame hex hole and hold in place for 45 seconds each. Let dry for 15 minutes then proceed to step 4 below.

STEP 4.

Next apply blue threadlocker to the two mounting bolts used to mount the mounting plate.

STEP 5.

Next install the mounting plate with binding barrels toward the bottom of the vehicle as shown in photo at right with the supplied 6mm screws and washers.

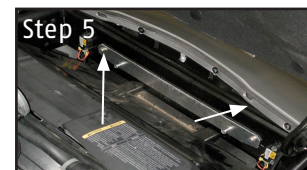
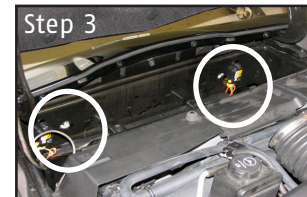
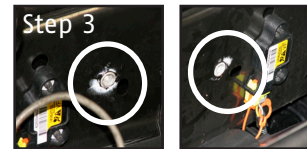

Mamotorworks



@CorvettePassion



MidAmericaMotorworks



CorvettePassion

2900 North Third Street, Effingham, IL 62401
 800.500.1500 • Worldwide: 217.540.4200 • FAX: 217.540.4800
www.mamotorworks.com • generalmail@mamotorworks.com
 ©Mid America Motorworks, Inc. All rights reserved.



Blackwing Induction System

STEP 6.

Remove the stock airbox mounting points and rubber locators from the stock radiator shroud and insert the supplied black pushpins to make a more factory look once the installation is complete.



STEP 7.

Next install the rubber grommets supplied into the SLP Blackwing filter as shown in the photo in Step 7.



STEP 8.

Next install the rubber grommet into the hole on the left side of the filter followed by the filter indicator.

STEP 9.

Next install the new SLP Blackwing filter onto the SLP Blackwing Air Horn as shown in the photo in Step 9.

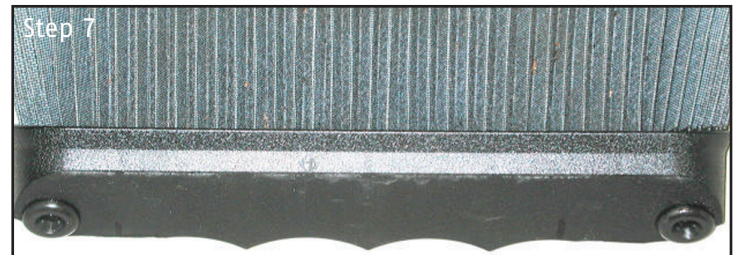

STEP 10.

Next, remove the STOCK MAF from the STOCK airbox assembly and install the MAF into the SLP Blackwing Airhorn using the SUPPLIED torx screws. Make sure the square rubber seal remains on the MAF when removing and installing. Only tighten the MAF screws until the backside of the MAF mounting surfaces touch the SLP black mounting standoffs then stop.

Make sure that the flow arrow is facing the outlet of the new Air bridge. The MAF can only install one way.



STEP 11.

Now install the filter and air bridge into the car. Be sure that the front grommets are pressed on the posts all the way. Insert the outlet of the air bridge into the factory bellows. Reconnect the MAF sensor connector to the MAF.

STEP 12.

Make any necessary adjustments to the intake and then tighten down all worm drive clamps.

STEP 13.

The installation is now complete. If any technical help is needed please call 800-500-1500.

