



Application: 1984-1996 C4 Corvette

Part Includes

1 - Window Regulator with Motor

Window Regulator w/ Motor



Tools Needed



Search: *Window*

www.mamotorworks.com

Note: 1987 Convertible & 1988-1996 Application is direct replacement of existing component. (See steps C&D)

A. Removal of C4 Corvette Window Regulator, 1984-1986 & 1987 Coupe:

STEP 1.

Run window glass to mid position, then loosen the three glass mounting nut and washer assemblies. Note location of studs in regulator slots.

STEP 2.

Separate glass from regulator and block glass with rubber-padded clamps above belt line. Remove the three glass mounting nut and washer assemblies, then lower glass.

STEP 3.

Disconnect electrical connector of regulator.

STEP 4.

Detach regulator from door by removing the two studs and nuts at top and three bolts at bottom. Remove regulator from door.

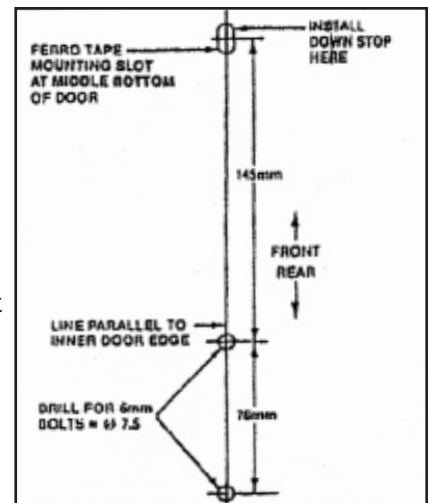

FIG 1

B. Retrofit Installation of C4 Corvette Window Regulator, 1984-1986 & 1987 Coupe:

STEP 1.

Lift window glass up out of way and retain with rubber padded clamps.

STEP 2.

Drill two holes for 6mm bolts in bottom of door as shown in Fig. 1.

STEP 3.

Replace center glass mounting stud with shorter stud or shorten original stud by 7mm. (see Fig. 2)

STEP 4.

Install rubber downstop in slot in bottom of door. (See Fig. 1)

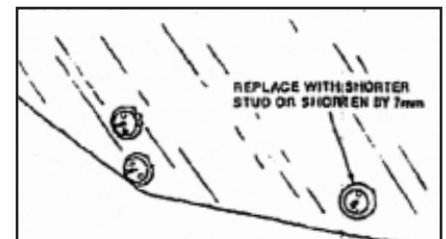

FIG 2



Mamotorworks



@CorvettePassion



MidAmericaMotorworks



CorvettePassion

2900 North Third Street, Effingham, IL 62401

800.500.1500 • Worldwide: 217.540.4200 • FAX: 217.540.4800

www.mamotorworks.com • generalmail@mamotorworks.com

©Mid America Motorworks, Inc. All rights reserved.



Description (cont.)

STEP 5.

Install regulator as follows. (See Fig. 3)

- With regulator lift arm at shifting position height (Approx. 140mm from bottom of lift arm to bottom of regulator), insert bottom of regulator into door. Then tilt lift arm up to get top mounting feet of regulator into door.
- Line up all four mounting feet with holes in door, then loosely install the two bottom bolts first. Loosely install the two top bolts, then tighten the bottom top bolts.
- On passenger side only, reverse the wire terminals in electrical connector.
- Remove electrical tape from wiring harness as needed to allow connector to reach new regulator location.

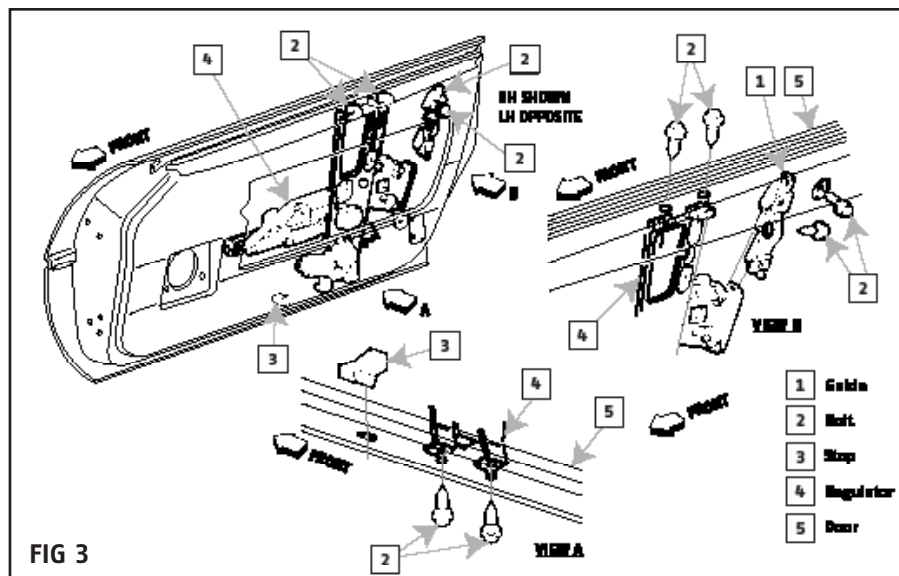

STEP 6.

Attach glass loosely to regulator with the three nut and washer assemblies. Position the glass studs in the regulator slots in approximately the same locations as noted in Section A Step 1.

STEP 7.

With door closed and with a helper outside to push against window glass, raise and adjust window so that edges of glass are against and centered on window seals. Tighten the three glass mounting nut and washer assemblies.

Note: Do not alter the front up stop bracket adjustment unless the window glass is being replaced. Do not alter the rear scissors up/down or in/out adjustments unless glass adjustment can not be obtained otherwise.

STEP 8.

When glass is properly adjusted, tighten the two top regulator mounting bolts.

STEP 9.

Lower and raise window glass several times to check operation and adjustments.



Description (cont.)

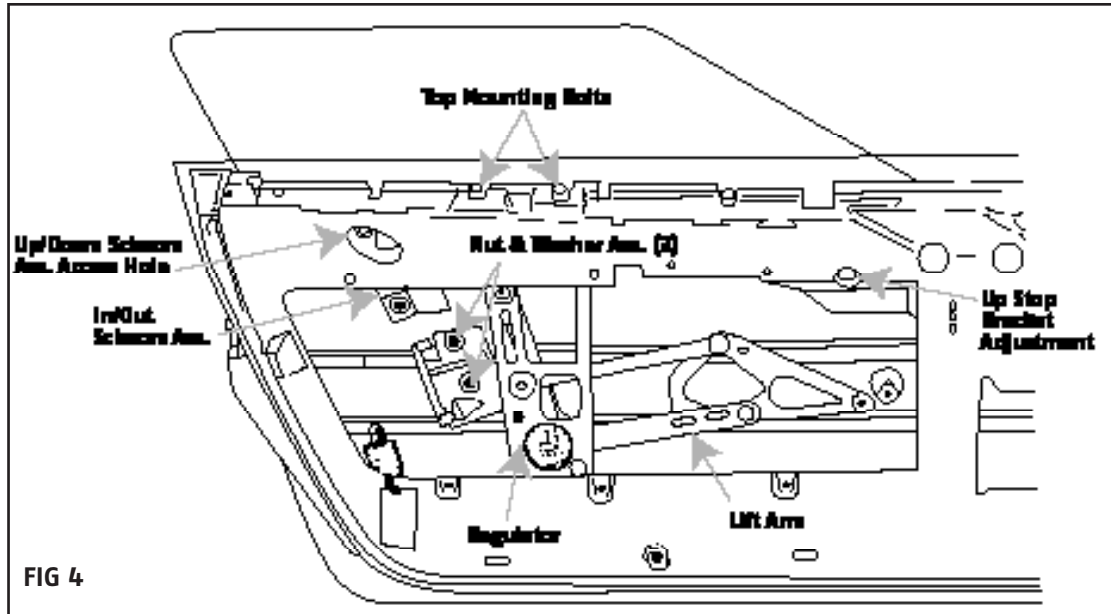

C. C4 Corvette Window Regulator Replacement of 1987 Convertible, 1988-1996 ALL.

STEP 1.

Remove armrest, accessory trim plate, and door trim panel

STEP 2.

Remove inner panel liner

STEP 3.

Disconnect the following linkages from the inner mounting plate:

- Power door lock linkage (clip)
- Latch handle linkage from guides on back of mounting plate and clip at latch handle
- Door lock rod from guide on back side of mounting plate and at pivot

STEP 4.

Remove bolts holding inner mounting plate

STEP 5.

Remove window guide

STEP 6.

Lower inner mounting plate into door and remove by tilting plate outward at the top

STEP 7.

Unclip wiring harness from inner mounting plate